

HALL 6
ENTRANCE

WHEELCHAIR
RAMP

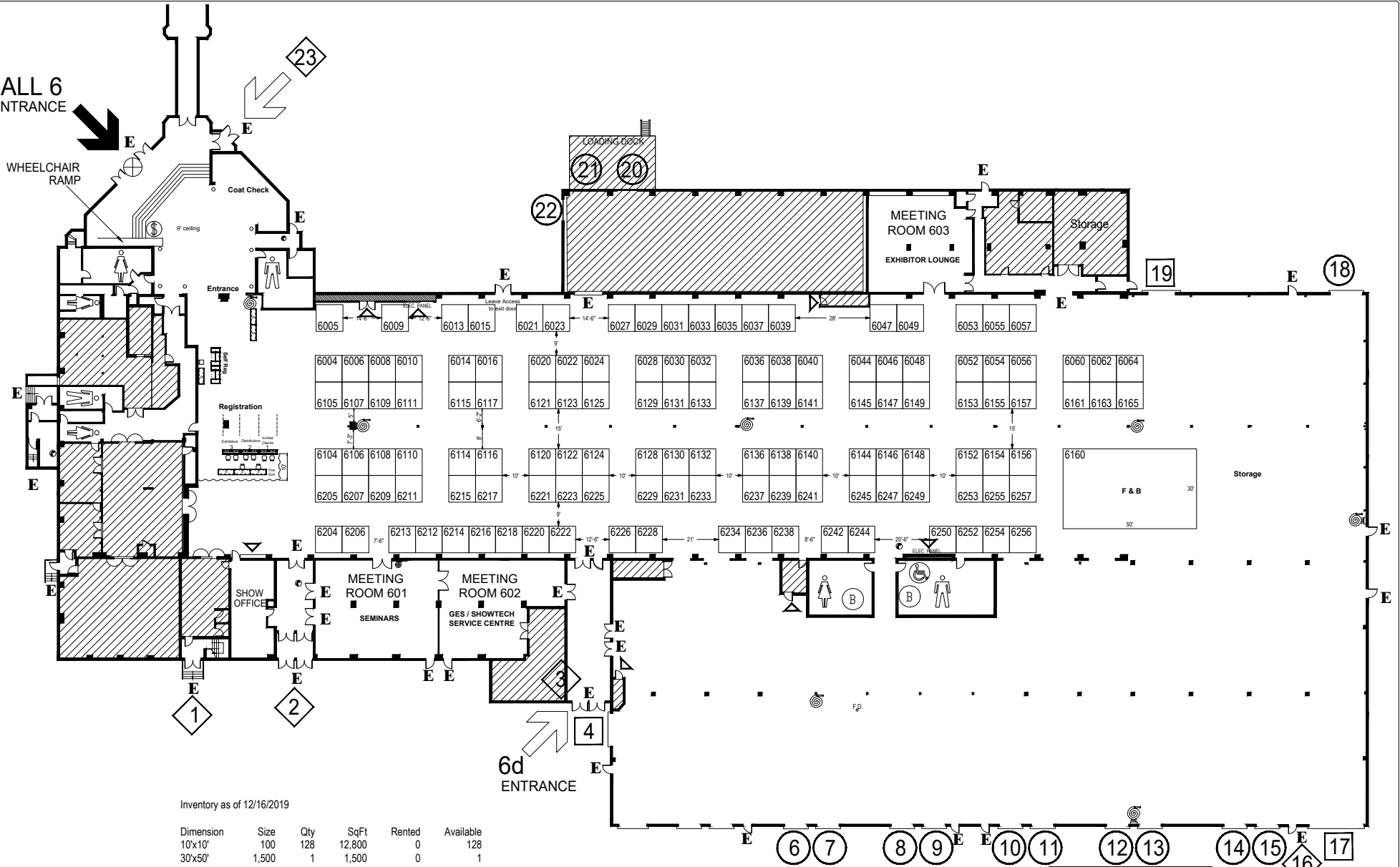

Inventory as of 12/16/2019

Dimension	Size	Qty	SqFt	Rented	Available
10'x10'	100	128	12,800	0	128
30'x50'	1,500	1	1,500	0	1
Totals:		129	14,300	0	129

CEILING CLEARANCE : 20'
o F.D. = FLOOR DRAIN



COPYRIGHT © 2010 Global Experience Specialists.
All Rights Reserved. No part of this publication may be reproduced, stored in any retrieval system, or transmitted in any form or by any means - electronic, mechanical, photocopying, recording, or otherwise - without the express written consent of Global Experience Specialists.
Every effort has been made to insure the accuracy of all information contained on this floor plan. However, no warranties, either expressed or implied, are made with respect to this floor plan. If the location of building columns, utilities, or other architectural components of the facility is a consideration in the construction or usage of an exhibit, it is the sole responsibility of the exhibitor to physically inspect the facility to verify all dimensions and locations.

TOPS+
February 6, 2020
The International Centre
Exhibit Hall 6

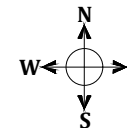

Confidential Property Of
Global Experience Specialists
File: TOPS20 Dec 16 19.dwg
Layout: Letter Dims
Plotted: December 16, 2019, 12:28:59 PM
By: Pirbhai, Nasera